

Maritime Museum

The Maritime Museum is at the heart of Liverpool's historic waterfront in the Royal Albert Dock Liverpool.

How to reach:

By Car:

Follow signposts for the Royal Albert Dock from the motorway and other main routes into the city centre. Please note that roadworks in Liverpool city centre may cause delays, so allow plenty of time for your journey. There are car parks on site in the Royal Albert Dock complex and in the nearby Liverpool One complex opposite the entrance to the Royal Albert Dock.

Parking:

Please note there is very limited car parking on site and we are not always able to reserve these spaces. Please reserve these for disabled guests only. There is a carpark on the dock which charges £15-£20 per day. There is also another underground Q Park which can be accessed on the Strand. We do offer a discount for the Q Park which can be accessed at the link below:

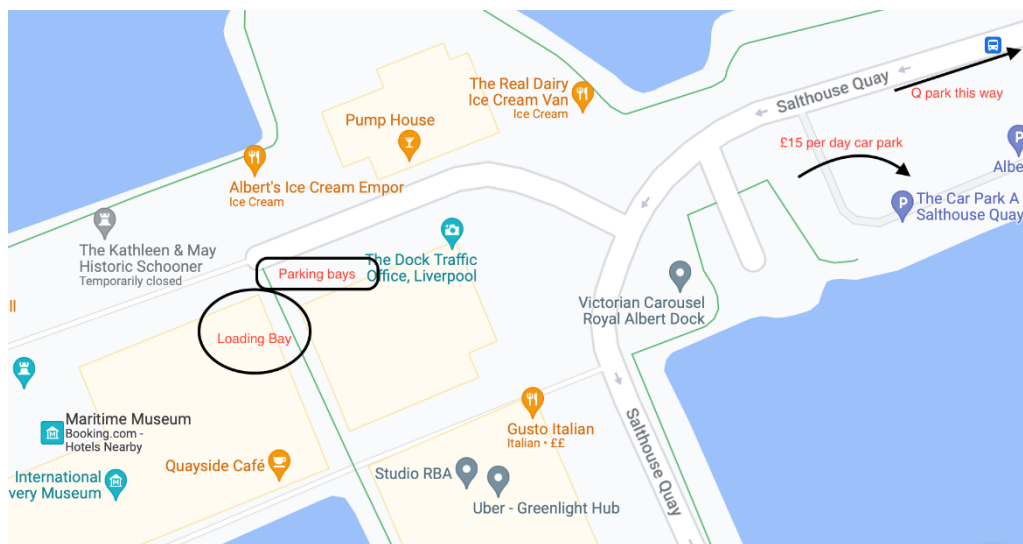

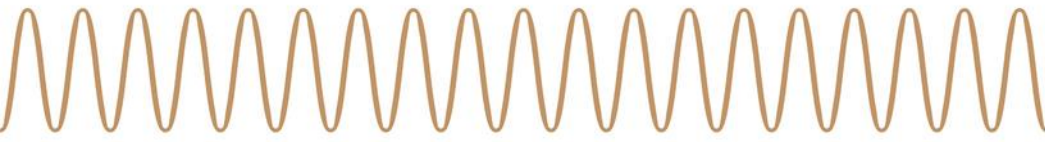

Car Park – Liverpool One
Discount – 20%
Code – MMQPLO20

Car park web page - <https://www.q-park.co.uk/en-gb/cities/liverpool/liverpool-one/>

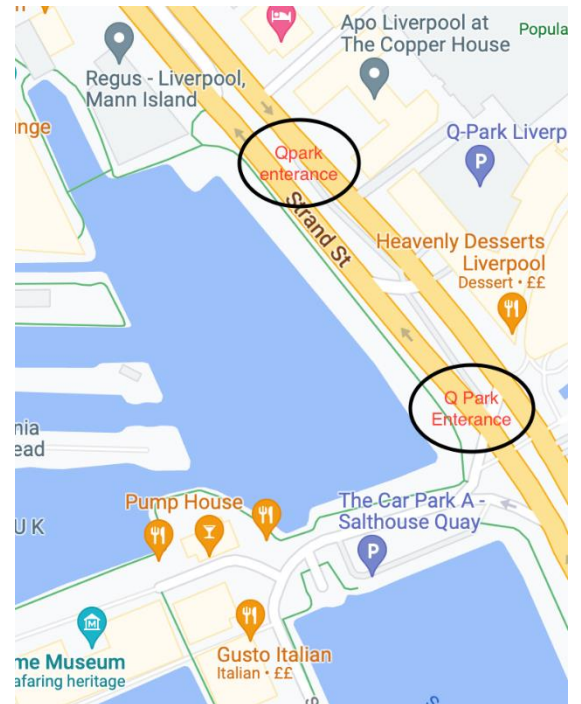

By Train:

James Street station is the closest station and is approximately a 5 minute walk away. If arriving at Lime Street Station the museum is approximately a 20 minute walk.

By Bus:

The nearest bus station is at Paradise Street, just across the road from the entrance to the Royal Albert Dock. National Express coaches stop here. The Queen Square bus interchange is about a 15 minute walk away, or the C4 city centre bus goes from Queen Square to the Royal Albert Dock.

Walking:

The Royal Albert Dock is a short walk from the centre, on Liverpool's historic waterfront.

Useful Information:

- No objects are to be touched under any circumstances.
- No food or drink allowed in any gallery spaces due to pest control and conservation requirements.
- No soil or plant matter of any kind within gallery spaces – for similar pest control and conservation reasons.
- No paints, inks, or similar substances are permitted in any NML site, especially art galleries.
- No Drinks to be consumed or moved through lifts

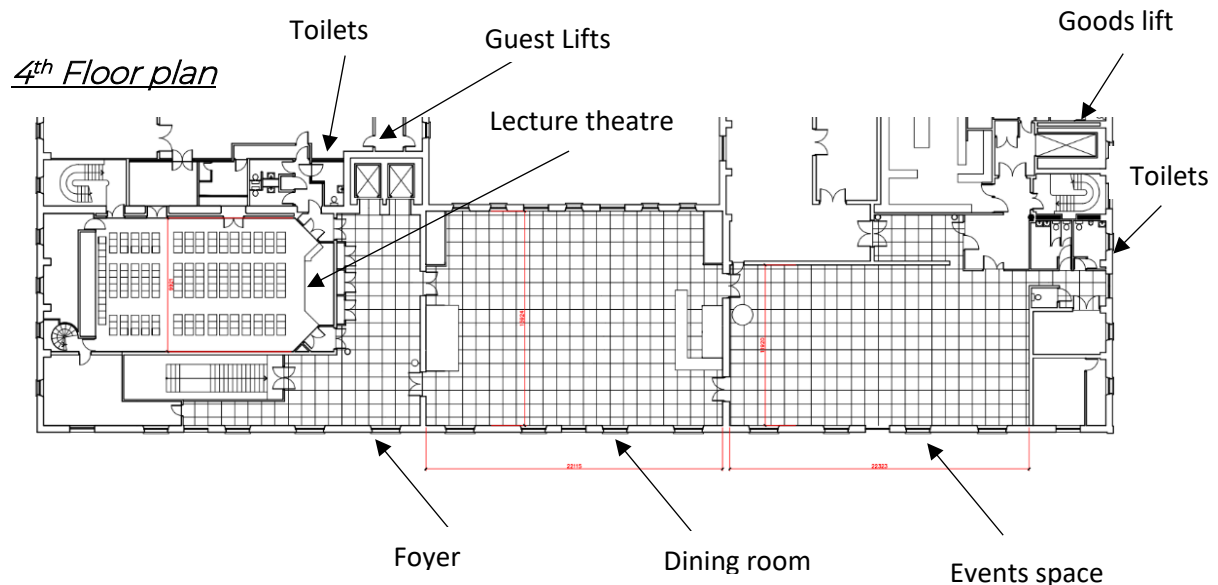
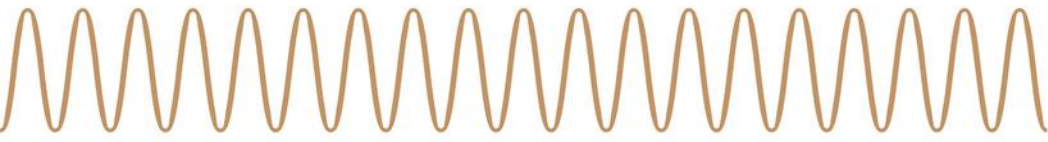

Nearest toilets:

There are toilets located between the lecture theatre and the lifts on the event floor.

There are also toilets at the back of the event floor. Both sets of toilets provides Males, Females and an accessible toilet.

In the unfortunate event of an evacuation:

- The fire bell will ring
- The event manager and staff will show you and your guests to the nearest fire exit
- A member of staff will take you to the ground floor and towards the muster point
- The muster point is located at the lamppost next to the big red bus.
- In the event of any wheelchair users evac chairs are provided on the events floor.
- A list of delegates will need to be provided to ensure everyone is out safely.
- Do NOT use the lifts
- Do NOT re-enter the building unless told to do so by your event manager.

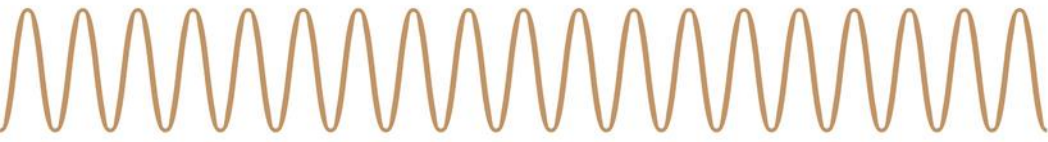

Loading Bay:

Spaces can be used for loading or unloading and where the van and is pictured below but must be moved once unloaded.



There is a buzzer on the left of the big doors. Please buzz to deliver to the Museum. Once inside there is a large lift (goods lift) around the corner and on the left. Once loaded please make sure that the doors are securely shut. There is a code located on the back of the door that will need inputting into the panel on the right.

DO NOT open the doors until the lift clicks into place.

Please ensure the doors are shut when finished with the lift.

Lift dimensions:

Height: 92 inches (7 ft 8 inches)

Width: 68 inches (5 ft 8 inches)

Length: 167 inches (13 ft 11 inches)

We look forward to welcoming you to the Maritime Museum and hope you enjoy the day with us.

If you would like to provide any feedback or have any questions please email event.operations@liverpoolmuseums.org.uk

Thank you and see you soon!

The Hosted By NML team